

IMPORTANT! RETAIN THIS MANUAL FOR FUTURE REFERENCE

**INSTRUCTION MANUAL
FOR USE OF CAR SEAT "NOMAD ISO"**

NOMAD ISO



This child restraint **chipolino** system is designed and manufactured in compliance with the requirements of Regulation 44 of the United Nations Economic Commission for Europe concerning the safe transportation of children, the provisions of the product safety directive 2001/95/EU of the European Parliament and The Council and Directive 91/671/EEC "Compulsory use of seat belts and child restraints systems for child occupants of power driven vehicles" of the European Parliament and The Council.

NOTICE

FOR GROUP I (9-18 kg)

1. This is ISOFIX CHILD RESTRAINT SYSTEM.. It is approved (№ E50 44R-040005), to Regulation No 44, 04 series of amendments for general use in vehicles fitted with Isofix anchorages systems.
2. It will fit vehicles with positions approved as ISOFIX positions (as detailed in the vehicle handbook), depending on the category of the child seat and of the fixture.
3. The group for which this device is intended is Group I (9-18 kg).

FOR GROUP II/III (15-36 kg)

1. This is a "UNIVERSAL" CHILD RESTRAINT SYSTEM. It is approved (№ E50 44R-040005), to Regulation No 44, 04 series of amendments, for general use in vehicles and it will fit most, but not all, car seats.
2. A correct fit is likely if the vehicle manufacturer has declared in the vehicle handbook that the vehicle is capable of accepting a "Universal" child restraint for this age group.
3. This child restraint has been classified as "Universal" under more stringent conditions than those which applied to earlier designs which do not carry this notice.
4. If in doubt, consult either the child restraint manufacturer or the retailer.

DO NOT FORGET THAT NO RESTRAINT SYSTEM CAN PROVIDE ABSOLUTE PROTECTION IN CASE OF A CRASH OR ROAD ACCIDENT! DRIVE WITH CARE WHEN THERE IS A CHILD IN YOUR VEHICLE!



IN ORDER TO ENSURE THE SAFETY OF YOUR CHILD, FOLLOW EXACTLY THE INSTRUCTIONS AND SAFETY RECOMMENDATIONS IN THIS MANUAL!

MISUSE OF THE CAR SEAT WILL CONTRIBUTE TO REDUCING ITS SECURITY AND SAFETY FEATURES! FAILURE OF THE GUIDELINES OF THIS INSTRUCTION INCREASES THE RISK OF SERIOUS INJURY OR DEATH!

PLACE OF THE CAR SEAT IN THE VEHICLE

The car seat is suitable for use in vehicles fitted with ISOFIX anchorage points and vehicles fitted with three-point static belt with a retractable mechanism that meets the requirements of Regulation № 16 of the Economic Commission for Europe of the United Nations!

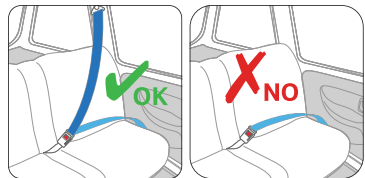



Do not place the restraint system "REARWARD FACING" on a seat equipped with air bag! This may result in death or serious injury! Review the instructions of the car seat for information about airbags and conditions of transportation of children.

Place the car seat only in forward-facing mode!



Do not place the car seat on seats facing to the sides or backwards!



- **CAUTION! NEVER LEAVE YOUR CHILD UNATTENDED!**
- **CAUTION! THE CAR SEAT MUST BE INSTALLED ONLY ACCORDING TO THE DESCRIBED INSTRUCTIONS IN THIS MANUAL. IT IS DANGEROUS TO USE ANCHOR POINTS OTHER THAN THE ONES GIVEN IN THIS MANUAL!**
- **CAUTION! USE THE LAP VEHICLE BELT IN SUCH WAY THAT IT STAYS LOW AT CHILD'S BODY AND HOLDS HIS PELVIS (Groups II/III).**
- **CAUTION! THE SAFETY HARNESS OF THE CAR SEAT (Group I) AND OF THE VEHICLE (Group II/III), THAT SECURE THE BABY, MUST BE WELL ATTACHED AND ADJUSTED ACCORDING TO THE CHILD'S SIZE.**
- **CAUTION! THIS CHILD RESTRAINT SHOULD NOT BE MODIFIED OR ADAPTED WITH NEW FITTINGS, WITHOUT PREVIOUS AUTHORIZATION BY THE COMPETENT AUTHORITY.**
- **CAUTION! KEEP AWAY FROM FIRE!**
- For children weighing from 9 up to 18 kg (group I) the restraint must be installed only through the isofix attachments of the car seat and the vehicle ISOFIX anchorages must be used. the safety harness of the child restraint system must be used for this group at all times!
- For children weighing 15 - 25 kg (group II) and 22 - 36 kg (group III) the restraint must be installed only in vehicles with approved 3-point diagonal/lap belts and ISOFIX anchorages! The child must be secured with the vehicle belts! Never install this seat in seats with 2 point belts.
- Installation in the vehicle and securing the child in the car seat to be done only by adult!
- The hard parts and the parts of the child restraint made of plastic should be located and installed so that when the vehicle is in normal use, they can not be trapped by a sliding seat or in a door of the vehicle.
- Always check if the vehicle belt is well attached and secures the child. It is very important that the lap belt is laying low and the child's hips are snug.
- Make sure the safety belts of the car seat and the vehicle are not twisted, frayed or torn, latches and locks (buckles) must be always in good order and firmly fixed.
- If you find defect or damage in the construction, latches, ISOFIX, straps or locking mechanisms of the car seat, discontinue usage until removal of the damaged parts and replacement with new ones.
- After a violent impact the car seat and belts may be damaged. therefore, it is recommended to replace the car seat with new one.
- Never use a second hand child restraint. it may have suffered structural damage, which may make the child restraint extremely dangerous.
- Do not use this car seat without its seat cover and do not replace it with a new one, unless supplied by the manufacturer. The fabric parts are integral parts of the restraint system and its safety features!
- Always make sure that you are not carrying any unsecured objects, especially on the back shelf, which, in case of an accident, may injure the car's occupants.
- Do not put additional pads except the ones supplied from the manufacturer! Placing additional pads may obscure the safety of your child.
- Do not use spare parts and other components not supplied by the manufacturer. The manufacturer assumes no responsibility for safety in the event that are used spare parts other than original.

- It is recommended to cover the car seat if the vehicle is parked under strong sun shine – extreme sun exposure will make the plastic to deteriorate and the fabric to fade. Please, check that the child restraint has not become too hot before placing your child seat.
- The car seat does not replace the child's cot or bed. When a child needs a sleep, you have to place him in a suitable baby stroller, baby crib or bed.
- Do not attach objects with long cords or strings on the car seat in order to avoid danger of suffocation!
- Never place a child seat on beds, couches or similar soft surfaces!
- Do not allow children to play with the product!
- Do not remove stickers and warnings – they contain important information!
- The packaging of the product must be kept out of the reach of children at the time of and after unpacking in order to avoid the risk of strangulation!

PRODUCT FEATURES

- Child restraint system suitable for children weighing 9 - 36 kg (Group I 9-18 kg, Group II 15-25 kg, Group III 22-36 kg);
- ISOFIX system;
- Anti-rotation device to limit the rotation in case of front impact;
- Backrest recline in 3 positions;
- Headrest height adjustment;
- 5-point safety harness.

MAIN PARTS DIAGRAM

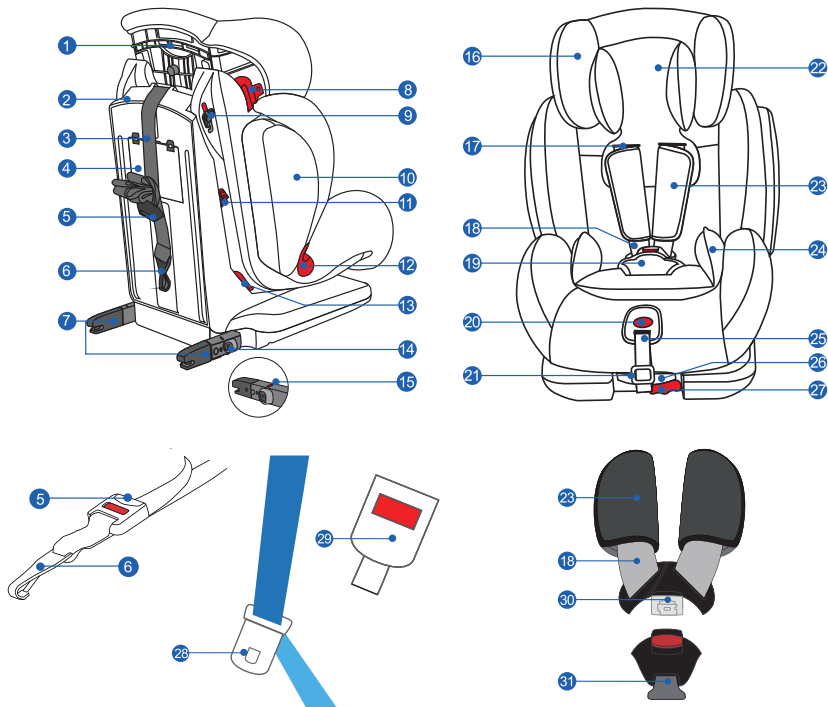

1. Headrest adjusting handle
2. Base
3. Top tether
4. User guide box

5. Top tether locker
6. Top tether lock hook
7. ISOFIX Connectors (x2)
8. Guide hook (for group II, 15-25kg)

- | | |
|--|---|
| 9. Shaft and lock | 21. Buckle of harness length adjustment strap |
| 10. Side armor | 22. Headrest cushion |
| 11. Lock clips (for group I, 9-18kg) | 23. Shoulder straps pads |
| 12. Lap belt guide (for group II, 15-25kg) | 24. Seat cushion |
| 13. Vehicle belt slots | 25. Harness adjustment strap |
| 14. ISOFIX point release buttons (x2) | 26. Recline Lever |
| 15. ISOFIX connection indicators | 27. ISOFIX system regulator |
| 16. Headrest | 28. Vehicle belt fastener |
| 17. Harness shoulder straps slots | 29. Vehicle belt buckle |
| 18. Harness shoulder straps | 30. Shoulder straps harness connectors |
| 19. Buckle pad | 31. Crotch strap |
| 20. Harness adjustment button | |

INSTRUCTION FOR USE

IMPORTANT!

- Follow exactly the instructions and safety recommendations in this manual.
- Check the security of fixing after each operation!
- ALWAYS CHECK THE SECURITY OF FIXING OF THE SAFETY BELTS!

CHILD CAR RESTRAINT, GROUP I (9-18 kg)

1 - Installing the car seat in the vehicle using the ISOFIX and top tether

IMPORTANT! Before installing the car seat in the vehicle, make sure that the ISOFIX release buttons (14) are unlocked (indicator (15) must be red).

IMPORTANT! After the installing the ISOFIX connectors to the ISOFIX vehicle anchorages, the indicator of ISOFIX connectors must be green, which confirms the correct installation (fig. 1-6).

IMPORTANT! After installing the top tether (3), to make sure that it is correctly fitted, make sure the indicator is green (fig. 1-8).

2- Adjusting the backrest recline

3 – Securing the child in the car seat

CAUTION! For children weighing 9 to 18 kg (group I) children must be secured with the 5-point harness of the car seat.

4 – Adjusting and removing the 5-point safety harness

You can adjust the shoulder straps height (18) by pressing the headrest adjusting handle (1).

IMPORTANT! The shoulder straps must be at child's shoulders level.

Note: Pull the harness shoulder straps, not the pads (23).

In order to remove the safety harness, follow the steps:

4-1 Loosen the harness by pressing the adjusting button. Grab the belts with your other hand and pull them towards you (20).

4-2 Remove the shaft (9) and split the backrest from the seat body (2).

CAUTION! Always lock the backrest to the body of the seat using the shaft.

4-3 Release the shoulder straps from the connector.

4-4 Remove the headrest upholstery.

4-5 Unscrew the washer cap, remove the belts from the metal connector. Remove the metal connector.

Note: After these steps, the headrest can be adjusted in higher position.

4-6 Pull out the belts from front side of the car seat.

4-7 Remove the buckle as shown.

4-8 Now you can remove all belts from the car seat.

CHILD CAR RESTRAINT SYSTEM, GROUP II (15-25kg) and GROUP III (22-36kg)

IMPORTANT! When using the car seat for children weighing 15 to 36 kg (groups II and III), you must remove the safety 5-point harness, as described in fig. 4-1 to fig. 4-8.

5 – Securing the child in the seat

CAUTION! Children weighing 15 to 36 kg (groups II and III) must be secured with the 3-point vehicle belt.

Place child in the car seat.

Thread the 3-point vehicle belt in front of child's body.

The diagonal belt must pass through the belt guide (8).

The lap belt must pass through the belt guides (12) and to be as low to child's hips as possible.

IMPORTANT! In fig. 5-3 and 5-4 you may see the correct and wrong ways to put the vehicle belt, as well as correct and wrong position of the vehicle belt buckle.

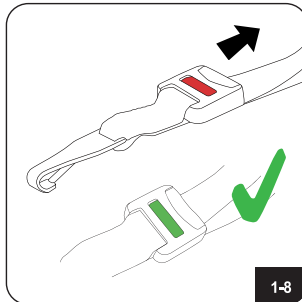
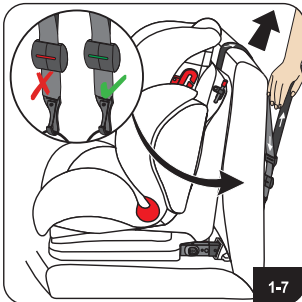
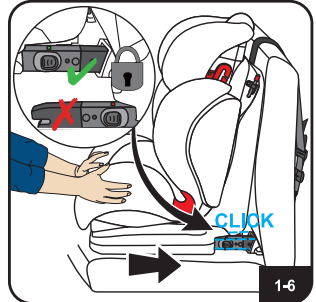
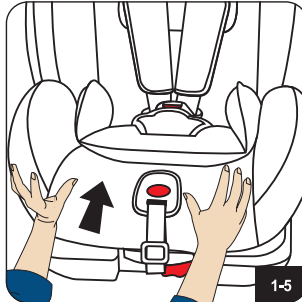
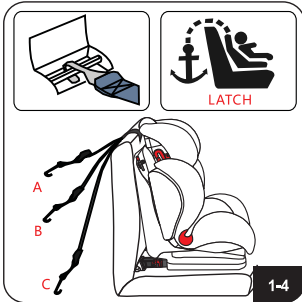
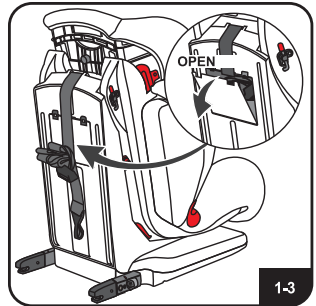
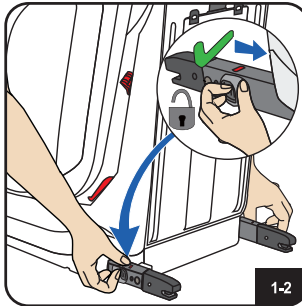
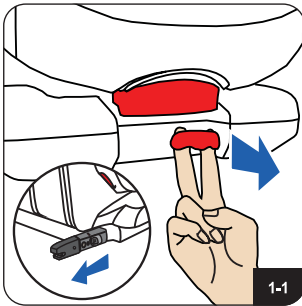

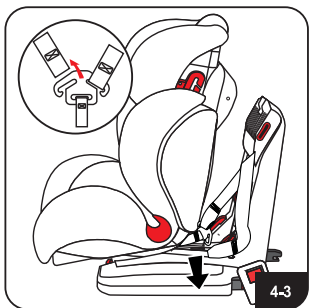
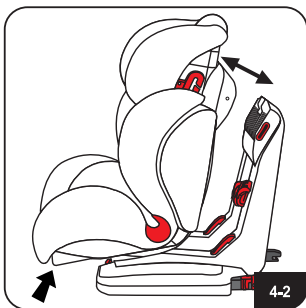
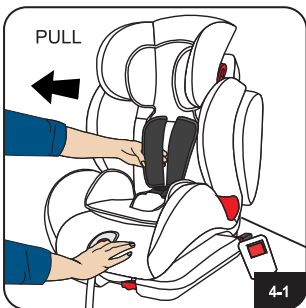
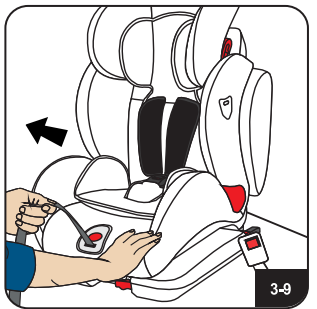
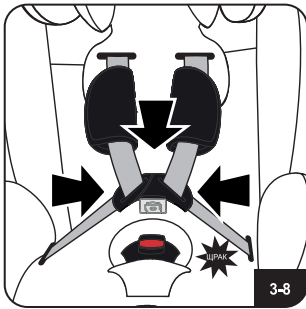
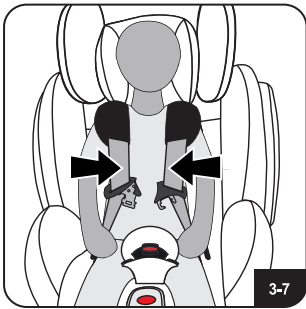
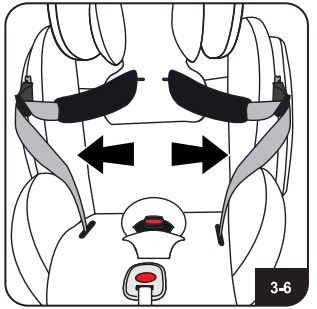
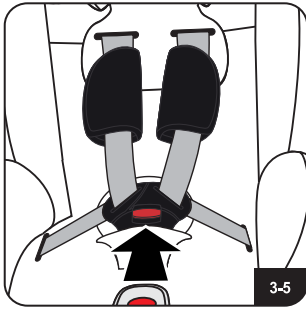
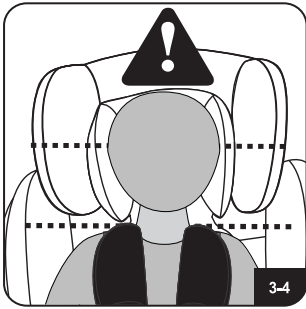
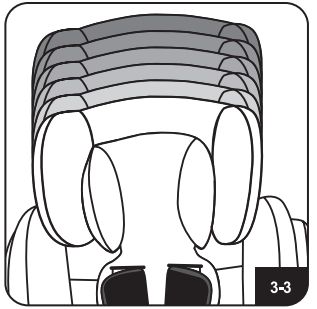
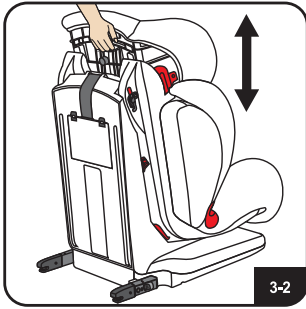
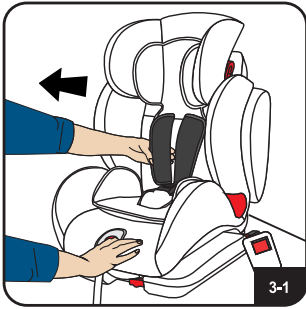

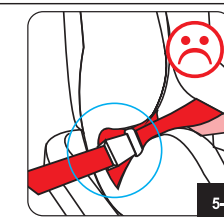
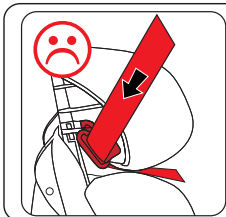
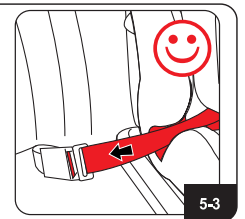
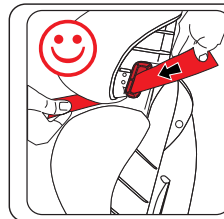
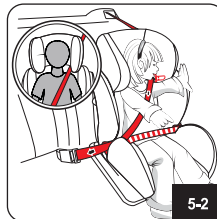
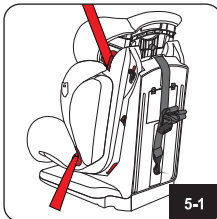
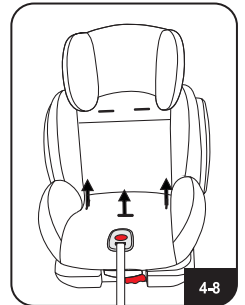
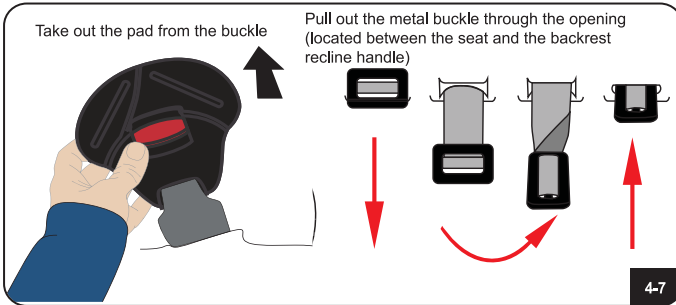
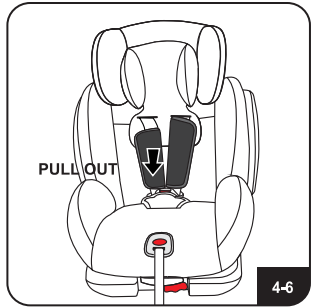
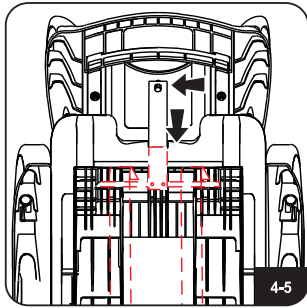
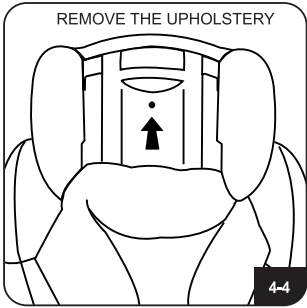

CLEANING AND MAINTENANCE INSTRUCTIONS

- Clean the fabrics, plastic parts and metal parts with damp cotton cloth or sponge and mild soap.
- Do not machine wash or bleach! Do not dry clean! Do not tumble dry! Do not iron!
- Do not use abrasive, bleach or other aggressive detergents.
- Always after cleaning leave the car seat fully dry and after that use it or store it.
- Harnesses must be cleaned with damp cloth and mild soap!
- Do not wet or remove the stickers. They contain important information!
- Always store your car seat indoors – on dry and clean place. Do not expose to direct environment influence - sun, rain, moisture and high temperature intervals.
- Please, contact your authorized dealer for problems connected with the use or repair

Fabric:

Outer: 100% polyester

Filling: 100% polyester



STKNO01XXXX

List of vehicle types with ISOFIX anchorage (brand / model / installation position)

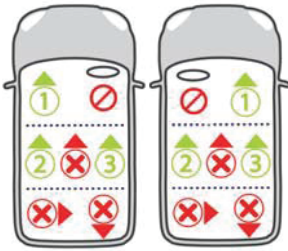

	1	2	3	1	2	3
Alfa Romeo						
Giulietta (2010 ->)	●	●	●	●	●	●
Mito (2009 ->)	●	●	●	●	●	●
Audi						
A1 (2011 ->)	●	●	●	●	●	●
A1 Sportback (2012 ->)	●	●	●	●	●	●
A3 Hatchback (2012 ->)	●	●	●	●	●	●
A3 S3 (2012 ->)	●	●	●	●	●	●
A4 Allroad (2009 ->)	●	●	●	●	●	●
A4 Av ant (2008 ->)	●	●	●	●	●	●
A4 Saloon (2008 ->)	●	●	●	●	●	●
A4 S4 (2009 ->)	●	●	●	●	●	●
A4 S4 Avant (2009 ->)	●	●	●	●	●	●
A5 (2007 ->)	●	●	●	●	●	●
A5 Sportback (2009 ->)	●	●	●	●	●	●
A5 S5 Sportback (2007 ->)	●	●	●	●	●	●
A6 (2011 ->)	●	●	●	●	●	●
A6 Allroad (2011 ->)	●	●	●	●	●	●
A6 Avant (2011 ->)	●	●	●	●	●	●
A6 S6 (2011 ->)	●	●	●	●	●	●
A7 Sportback (2011 ->)	●	●	●	●	●	●
A8 (2011 ->)	●	●	●	●	●	●
A8 S8 (2011 ->)	●	●	●	●	●	●
Q3 (2013 ->)	●	●	●	●	●	●
Q5 (2009 ->)	●	●	●	●	●	●
Q7 (2006 ->)	●	●	●	●	●	●
TT Coupe (2006 ->)	●	●	●	●	●	●
Bentley						
Continental GT (2003 - 2011)	●	●	●	●	●	●
Continental Flying Spur (2005 - 2012)	●	●	●	●	●	●
BMW						
1 Series Convertible (2008 ->)	●	●	●	●	●	●
1 Series Coupe (2008 ->)	●	●	●	●	●	●
1 Series F20 (2011 ->)	●	●	●	●	●	●
3 Series Coupe (2007 ->)	●	●	●	●	●	●
3 Series F30 (2012 ->)	●	●	●	●	●	●
5 Series M5 (2005 - 2011)	●	●	●	●	●	●
5 Series Saloon (2003 - 2010)	●	●	●	●	●	●
5 Series Touring (2011 ->)	●	●	●	●	●	●
5 Series Touring (2003 - 2010)	●	●	●	●	●	●
5 Series (2011 ->)	●	●	●	●	●	●
6 Series Coupe (2011 ->)	●	●	●	●	●	●
6 Series Convertible (2011 ->)	●	●	●	●	●	●
6 Series Gran Coupe (2011 ->)	●	●	●	●	●	●
7 Series (2010 ->)	●	●	●	●	●	●
X3 F25 (2011 ->)	●	●	●	●	●	●
X5 (2007 ->)	●	●	●	●	●	●
X5 (2006 ->)	●	●	●	●	●	●
X6 M (2008 ->)	●	●	●	●	●	●
6-GT (2010 ->)	●	●	●	●	●	●
Cadillac						
BLS Saloon (2006 - 2011)	●	●	●	●	●	●
Chevrolet						
Aveo 5dr (2012 ->)	●	●	●	●	●	●
Aveo 3dr (2012 ->)	●	●	●	●	●	●
Captiva (2007 ->)	●	●	●	●	●	●
Cruze (2009 ->)	●	●	●	●	●	●
Chrysler						
Grand Voyager (2008 ->)	●	●	●	●	●	●
300 C (2012 ->)	●	●	●	●	●	●
Delta (2011 ->)	●	●	●	●	●	●
Ypsilon (2011 ->)	●	●	●	●	●	●
Citroen						
Berlingo Multispace (2007 ->)	●	●	●	●	●	●
C1 (2005 ->)	●	●	●	●	●	●
C3 5 Door (2009 ->)	●	●	●	●	●	●
C3 Picasso (2009 ->)	●	●	●	●	●	●
C4 (2010 ->)	●	●	●	●	●	●
C4 Picasso (2007 ->)	●	●	●	●	●	●
C5 Saloon (2008 ->)	●	●	●	●	●	●
C5 Tourer (2008 ->)	●	●	●	●	●	●
DS3 (2010 ->)	●	●	●	●	●	●
DS4 (2011 ->)	●	●	●	●	●	●
DS5 (2013 ->)	●	●	●	●	●	●
Dacia						
Duster (2012 ->)	●	●	●	●	●	●
Sandero (2013 ->)	●	●	●	●	●	●
Fiat						
500 (2008 ->)	●	●	●	●	●	●
500 C (2009 ->)	●	●	●	●	●	●
Abarth 500 (2009 ->)	●	●	●	●	●	●
Bravo (2007 ->)	●	●	●	●	●	●
Ford						
B Max (2012 ->)	●	●	●	●	●	●
C Max (2003 ->)	●	●	●	●	●	●
Fiesta (2008 ->)	●	●	●	●	●	●
Focus (2010 ->)	●	●	●	●	●	●
Focus CMax (2003 - 2010)	●	●	●	●	●	●
Galaxy (2006 ->)	●	●	●	●	●	●
KA (2009 ->)	●	●	●	●	●	●
Kuga (2013 ->)	●	●	●	●	●	●
Mondo Estate (2007 ->)	●	●	●	●	●	●
Mondéo Hatchback (2007 ->)	●	●	●	●	●	●
Mondéo Saloon (2007 ->)	●	●	●	●	●	●
S Max (2006 ->)	●	●	●	●	●	●
Honda						
Accord Saloon (2008 ->)	●	●	●	●	●	●
Accord Tourer (2008 ->)	●	●	●	●	●	●
Civic (2012 ->)	●	●	●	●	●	●
Civic (2006 - 2011)	●	●	●	●	●	●
Civic Hybrid Saloon (2006 - 2010)	●	●	●	●	●	●
Civic Type R (2007 - 2010)	●	●	●	●	●	●
CRV (2007 - 2013)	●	●	●	●	●	●
FRV (2006 - 2011)	●	●	●	●	●	●
Insight (2009 ->)	●	●	●	●	●	●
Jazz (2008 ->)	●	●	●	●	●	●
Hyundai						
i10 Hatchback (2008 ->)	●	●	●	●	●	●
i20 Hatchback (2009 ->)	●	●	●	●	●	●
i30 (2012 ->)	●	●	●	●	●	●
i40 (2011 ->)	●	●	●	●	●	●
iX20 (2010 ->)	●	●	●	●	●	●
iX35 (2010 ->)	●	●	●	●	●	●
SantaFe (2012 ->)	●	●	●	●	●	●
Tucson (2010 ->)	●	●	●	●	●	●
Veloster (2012 ->)	●	●	●	●	●	●
Infiniti						
EX (2009 ->)	●	●	●	●	●	●
FX (2009 ->)	●	●	●	●	●	●
G Coupe (2009 ->)	●	●	●	●	●	●
G Saloon (2009 ->)	●	●	●	●	●	●
M (2010 ->)	●	●	●	●	●	●
Jaguar						
X-Type (2001 - 2010)	●	●	●	●	●	●
X-Type estate (2004 - 2010)	●	●	●	●	●	●
XF (2008 ->)	●	●	●	●	●	●
XF R (2009 ->)	●	●	●	●	●	●
Santafre (2013 ->)	●	●	●	●	●	●
XF Sportbrake (2013 ->)	●	●	●	●	●	●
XJ (2010 ->)	●	●	●	●	●	●
XK (2006 ->)	●	●	●	●	●	●
XK Convertible (2006 ->)	●	●	●	●	●	●
XK R (2006 ->)	●	●	●	●	●	●
Jeep						
Grand Cherokee (2011 ->)	●	●	●	●	●	●
Compass (2011 ->)	●	●	●	●	●	●

Brand	Model	1			2			3			Brand	Model	1			2			3										
		1	2	3	1	2	3	1	2	3			1	2	3	1	2	3	1	2	3								
Kia	Ceed Hatchback (2012 ->)	●	●	●	●	●	●	●	●	●	6 Estate (2008 - 2012) 6 Hatchback (2007 - 2012) 6 Saloon (2007 - 2009) 6 Saloon (2013 ->) 6 Estate (2012 ->)	Mitsubishi	ASX (2010 ->)	●	●	●	●	●	●	●	●	●	●	●	●	●	●	●	
	Optima (2012 ->)	●	●	●	●	●	●	●	●	●			Colt (2007 ->)	●	●	●	●	●	●	●	●	●							
	Picanto (2008 ->)	●	●	●	●	●	●	●	●	●			Miev (2009 - 2012)	●	●	●	●	●	●	●	●	●							
	Rio (2012 ->)	●	●	●	●	●	●	●	●	●			Lancer (2008 - 2011)	●	●	●	●	●	●	●	●	●							
	Sorento (2012 ->)	●	●	●	●	●	●	●	●	●			Lancer Sportback (2008 - 2011)	●	●	●	●	●	●	●	●	●							
	Scul (2009 ->)	●	●	●	●	●	●	●	●	●			Lancer Ralliart (2009 - 2011)	●	●	●	●	●	●	●	●	●							
Land Rover	Sportage (2011 ->)	●	●	●	●	●	●	●	●	●	Mercedes Benz	A Class (2005 - 2012) A Class (2013 ->) B Class (2012 ->) C Class (2008 ->) C Class Estate (2008 ->) C Class Coupe (2011 ->) CLA (2013 ->) CLS Shootingbrake (2012 ->) CLS Coupe (2011 ->) E Class (2009 ->) E Class Coupe (2009 ->) E Class Estate (2009 ->) E Class Saloon (2013 ->) GL Class (2006 - 2012) M/ML Class (2005 - 2012) R Class (2008 - 2012) S Class (2006 - 2013) SL Class (2012 ->) F SLK (2011 ->) F	Outlander (2007 - 2013)	●	●	●	●	●	●	Shogun (2007 ->)	●	●	●	●	●	●	●	●	●
	Venga (2010 ->)	●	●	●	●	●	●	●	●	●	Nissan		Juke (2010 ->)	●	●	●	●	●	●	●	●	●							
	Discovery 4 (2009 ->)	●	●	●	●	●	●	●	●	●	Micro (2011 ->)		●	●	●	●	●	●	●	●	●								
	Freelander 2 (2006 ->)	●	●	●	●	●	●	●	●	●	Note (2006 ->)		●	●	●	●	●	●	●	●	●								
	Range Rover (2013 ->)	●	●	●	●	●	●	●	●	●	Qashqai+2 (2008 ->)		●	●	●	●	●	●	●	●	●								
	Range Rover Sport (2005 - 2012)	●	●	●	●	●	●	●	●	●	X-Trail (2007 ->)		●	●	●	●	●	●	●	●	●								
Lexus	Range Rover Evoque (2011 ->)	●	●	●	●	●	●	●	●	●	Opel	Adam (2013 ->)	●	●	●	●	●	●	●	●	●								
	CT (2011 ->)	●	●	●	●	●	●	●	●	●	Agila (2008 ->)	●	●	●	●	●	●	●	●	●									
	IS Saloon (2005 - 2012)	●	●	●	●	●	●	●	●	●	Ampera (2011 ->)	●	●	●	●	●	●	●	●	●									
Mazda	RX (2010 ->)	●	●	●	●	●	●	●	●	●	Antara (2007 ->)	●	●	●	●	●	●	●	●	●									
	CX-5 (2011 ->)	●	●	●	●	●	●	●	●	●	Astra 5dr (2010 ->)	●	●	●	●	●	●	●	●	●									
	CX-7 (2007 - 2011)	●	●	●	●	●	●	●	●	●	Astra GTC (2011 ->)	●	●	●	●	●	●	●	●	●									
Mini	2 (2007 ->)	●	●	●	●	●	●	●	●	●	Corsa D (2007 - 2012)	●	●	●	●	●	●	●	●	●									
	2 Saloon (2007 ->)	●	●	●	●	●	●	●	●	●	Corsa 3dr Hatchback (2006 ->)	●	●	●	●	●	●	●	●	●									
	3 Hatchback (2009 ->)	●	●	●	●	●	●	●	●	●	Corsa 5dr Hatchback (2006 ->)	●	●	●	●	●	●	●	●	●									
	3 Saloon (2009 ->)	●	●	●	●	●	●	●	●	●	Corsa VXR (2007 ->)	●	●	●	●	●	●	●	●	●									
	5 (2005 ->)	●	●	●	●	●	●	●	●	●	Insignia Hatchback (2009 ->)	●	●	●	●	●	●	●	●	●									

Brand	Model	1			2			3			Brand	Model	1			2			3												
		1	2	3	1	2	3	1	2	3			1	2	3	1	2	3	1	2	3										
Peugeot	Mokka (2013 ->)	●	●	●	●	●	●	●	●	●	Laguna (2008 - 2012) Laguna Sport Tourer (2008 - 2012) Megane Hatchback (2008 ->) Megane Saloon (2006 - 2009) Megane Tourer (2006 - 2009) Megane Sport (2006 - 2009) Megane Sport Tourer (2009 ->) Modus (2004 - 2012) Grand Modus (2008 - 2012) Scenic (2009 ->) Twingo (2012 ->)	Skoda	Leon (2013 ->)	●	●	●	●	●	●	●	●	●	●	●	●	●	●	●	●	●	●
	Zafira (2005 ->)	●	●	●	●	●	●	●	●	●			Mi (2012 ->)	●	●	●	●	●	●	●	●	●									
	Zafira VXR (2005 ->)	●	●	●	●	●	●	●	●	●			Toledo (2013 ->)	●	●	●	●	●	●	●	●	●									
	107 (2005 ->)	●	●	●	●	●	●	●	●	●			Smart	For Two Coupe (2007 ->)	●	●	●	●	●	●	●	●	●								
	207 3dr (2006 - 2012)	●	●	●	●	●	●	●	●	●			Seat	Ahambra (2010 ->)	●	●	●	●	●	●	●	●	●								
	207 5dr (2006 - 2012)	●	●	●	●	●	●	●	●	●			Altea (2004 - 2011)	●	●	●	●	●	●	●	●	●									
	207 SW (2007 - 2012)	●	●	●	●	●	●	●	●	●			Altea XL (2007 - 2011)	●	●	●	●	●	●	●	●	●									
	208 3dr (2013 ->)	●	●	●	●	●	●	●	●	●			Altea Freerack (2007 - 2009)	●	●	●	●	●	●	●	●	●									
	208 5dr (2013 ->)	●	●	●	●	●	●	●	●	●			Exeo (2008 ->)	●	●	●	●	●	●	●	●	●									
	307 (2001 - 2007)	●	●	●	●	●	●	●	●	●			Exeo ST Estate (2008 ->)	●	●	●	●	●	●	●	●	●									
	307 Estate (2002 - 2007)	●	●	●	●	●	●	●	●	●			Ibiza Cupra (2009 ->)	●	●	●	●	●	●	●	●	●									
	308 Hatchback (2008 ->)	●	●	●	●	●	●	●	●	●			Ibiza FR (2009 ->)	●	●	●	●	●	●	●	●	●									
Porsche	308 SW (2008 ->)	●	●	●	●	●	●	●	●	●	Seat	Leon (2013 ->)	●	●	●	●	●	●	●	●	●										
	309S (2009 ->)	●	●	●	●	●	●	●	●	●	Alhambra (2010 ->)	●	●	●	●	●	●	●	●	●											
	4008 (2011 ->)	●	●	●	●	●	●	●	●	●	Altea XL (2007 - 2011)	●	●	●	●	●	●	●	●	●											
	508 (2011 ->)	●	●	●	●	●	●	●	●	●	Altea Freerack (2007 - 2009)	●	●	●	●	●	●	●	●	●											
	508 SW (2011 ->)	●	●	●	●	●	●	●	●	●	Exeo (2008 ->)	●	●	●	●	●	●	●	●	●											
	508 RXR (2013 ->)	●	●	●	●	●	●	●	●	●	Exeo ST Estate (2008 ->)	●	●	●	●	●	●	●	●	●											
Renault	508 (2010 ->)	●	●	●	●	●	●	●	●	●	Ibiza Cupra (2009 ->)	●	●	●	●	●	●	●	●	●											
	Cayenne (2011 ->)	●	●	●	●	●	●	●	●	●	Leon Cupra (2007 - 2011)	●	●	●	●	●	●	●	●	●											
	Panamera (2011 ->)	●	●	●	●	●	●	●	●	●	Leon FR (2006 - 2012)	●	●	●	●	●	●	●	●	●											
Renault	Clio (2013 ->)	●	●	●	●	●	●	●	●	●	Leon Hatchback (2005 - 2012)	●	●	●	●	●	●	●	●	●											
	Clio (2005 - 2012)	●	●	●	●	●	●	●	●	●	Mervia (2010 ->)	●	●	●	●	●	●	●	●	●											
	Clio Renault Sport (2006 - 2012)	●	●	●	●	●	●	●	●	●	Mini	Mini Hatchback (2006 ->)	●	●	●	●	●	●	●	●	●										

Brand	Model	1			2			3			Brand	Model	1			2			3									
		1	2	3	1	2	3	1	2	3			1	2	3	1	2	3	1	2	3							
Toyota	Auris (2007 - 2012)	●	●	●	●	●	●	●	●	●	Insignia Sports Tourer (2009 ->)	Volvo	C30 (2007 - 2012)	●	●	●	●	●	●	●	●	●	●	●	●	●	●	●
	Avenis Hatchback (2009 ->)	●	●	●	●	●	●	●	●	●			Mervia (2010 ->)	●	●	●	●	●	●	●	●	●						
	Auris (2013 ->)	●	●	●	●	●	●	●	●	●			Mokka (2013 ->)	●	●	●	●	●	●	●	●	●						
	Avenis Tourer (2009 ->)	●	●	●	●	●	●	●	●	●			Zafira (2005 ->)	●	●	●	●	●	●	●	●	●						
	Aggs (2005 ->)	●	●	●	●	●	●	●	●	●			Zafira VXR (2005 - 2010)	●	●	●	●	●	●	●	●	●						
	GT86 (2012 ->)	●	●	●	●	●	●	●	●	●			Volkswagen	Beetle (2012 ->)	●	●	●	●	●	●	●	●	●					
	Land Cruiser (2003 - 2009)	●	●	●	●	●	●	●	●	●			Multivan Caravelle (2003 ->)	●	●	●	●	●	●	●	●	●						
	Land Cruiser (2009 ->)	●	●	●	●	●	●	●	●	●			Golf Cabriolet (2009 - 2012)	●	●	●	●	●	●	●	●	●						
	Plus (2004 - 2009)	●	●	●	●	●	●	●	●	●			Golf Cabriolet (2009 - 2012)	●	●	●	●	●	●	●	●	●						
	Prius (2009 ->)	●	●	●	●	●	●	●	●	●			Golf Hatchback (2009 - 2012)	●	●	●	●	●	●	●	●	●						
	Prius Plus (2012 ->)	●	●	●	●	●	●	●	●	●			Golf Hatchback MK7 (2012 ->)	●	●	●	●	●	●	●	●	●						
	RAV4 (2013 ->)	●	●	●	●	●	●	●	●	●			Golf GTI (2009 - 2012)	●	●	●	●	●	●	●	●	●						
Vauxhall	Adams (2013 ->)	●	●	●	●	●	●	●	●	●	Golf Plus (2009 - 2011)	●	●	●	●	●	●	●	●	●								
Adam (2013 ->)	●	●	●	●	●	●	●	●	●	Jetta (2011 ->)	●	●	●	●	●	●	●	●	●									
Agila (2008 ->)	●	●	●	●	●	●	●	●	●	Passat (2010 ->)	●	●	●	●	●	●	●	●	●									
Ampera (2011 ->)	●	●	●	●	●	●	●	●	●	Passat (2005 - 2010)	●	●	●	●	●	●	●	●	●									
Antara (2007 ->)	●	●	●	●	●	●	●	●	●	Passat Alltrack (2012 ->)	●	●	●	●	●	●	●	●	●									
Astra 5dr (2010 ->)	●	●	●	●	●	●	●	●	●	Passat CC (2008 ->)	●	●	●	●	●	●	●	●	●									
Astra Estate (2010 ->)	●	●	●	●	●	●	●	●	●	Passat Estate (2005 ->)	●	●	●	●	●	●	●	●	●									
Astra GTC (2011 ->)	●	●	●	●	●	●	●	●	●	Polo 3dr (2009 ->)	●	●	●	●	●	●	●											



1 Golyamokonarsko shosse, Plovdiv, BULGARIA
www.chipolino.com